

## PFA lined CAMLOCK DP

### TYPE PLDP

**Fitting standard:** A-A-59326/DIN 2828.

FEP or PTFE liners are available.

Virgin and anti-static liners are available.

**Remark:** Can be customized.

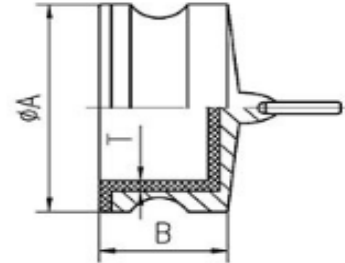

| Part no.  | Fitting material | Size   | D $\pm$ 0.1<br>mm | D2 min<br>mm |
|-----------|------------------|--------|-------------------|--------------|
| PLDP019S6 | SS316+PFA        | 3/4"   | 32.1              | 37.0         |
| PLDP025S6 | SS316+PFA        | 1"     | 36.7              | 45.0         |
| PLDP032S6 | SS316+PFA        | 1-1/4" | 45.5              | 52.0         |
| PLDP038S6 | SS316+PFA        | 1-1/2" | 53.4              | 53.0         |
| PLDP050S6 | SS316+PFA        | 2"     | 63.0              | 59.0         |
| PLDP063S6 | SS316+PFA        | 2-1/2" | 75.8              | 62.0         |
| PLDP076S6 | SS316+PFA        | 3"     | 91.5              | 64.0         |
| PLDP102S6 | SS316+PFA        | 4"     | 119.5             | 66.0         |